

Kaba c-lever compact

More than just a door handle



Door handle with a Difference

Innovation and high-quality design in one: The Kaba c-lever compact is an electronic door fitting solution. It can replace a mechanical lever handle and is completely independent from the cylinder. In no time your mechanical door handle becomes a flexible electronic door solution with the option of granting access rights temporarily or permanently, and blocking them quickly if a key is lost.

The c-lever compact is part of the Kaba evoluo product family. This product line has won design prizes, and is operated using RFID media. Thanks to the standalone operation, no cables need to be installed - an easy installation with just two screws. Previously this was only possible for mechanical door handle sets.

A large number of beneficial applications are conceivable: doors can easily be equipped with this electronic access control, while the existing locking system can still be used independently, for example for mechanical emergency opening.

Areas of application

In principle, the Kaba c-lever compact is suitable for most inside or outside doors that are protected against weather.

Almost any room can be organised using this electronic solution. For example, access rights are given to different user groups or individual persons for different rooms on different dates and at varying times, permanently or temporarily.

Vorteile auf einen Blick

- Practical and quick
- Existing mechanical doors can be refitted in just a few minutes
- Autonomous
- Independent of locking cylinder and lock type, parallel operation to the existing locking system is possible
- Innovative design
- Modern, consistent design and part of the award-winning Kaba evoluo product range
- Cost-conscious
- Minimal maintenance costs due to standard AAA batteries
- Supports NFC
- Ready for use with devices with NFC capability (Near Field Communication)
- Investment protection
- System allows future function expansions as well as the integration into existing Kaba locking systems



Performance characteristics

Intuitive user guidance

The RFID access medium is held in front of the reading unit. An acoustic signal and light (green/red) indicates if access has been granted or denied. The room can be entered normally by pushing the door handle.

Easy planning

This solution, which is independent from locks and cylinders, is ideally suited to upgrade a mechanical locking system: a simple replacement of the mechanical door handle converts an existing locking system into an electronic access control solution.

Easy assembly

Installation can be carried out on doors made of wood, glass or metal. Ideally, interior or outside areas protected against weather. In most cases, the existing boreholes on the door can be used so that that installation is performed in just a few minutes.

Scalable field of application

The Kaba c-lever compact is suitable both for the individual door and as an element of a large locking system. Kaba offers various programming options depending on the size and requirements:

- Manual programming with the master card on site for a few doors
- Programming using the Kaba evolvo Manager Software (KEM) and the programming device for small and medium-sized systems
- Programming directly onto the access medium with Kaba CardLink and the Kaba exos 9300 online software for large and complex locking systems.

CheckIn operation

The Kaba evolvo Manager Software offers the option for a special »CheckIn operation« which manages access for small hotels and guest houses. Access cards are individually programmed when guests arrive, using the desktop reader which is connected to the computer via USB.

Important Kaba evolvo features

- Integrated Kaba security concept
- Administration of an unlimited number of media
- Event memory for up to 2,000 door movements (can be switched off)
- 15 configurable time profiles, each with 12 time windows
- 20 holiday periods and 64 special days
- Time-limited granting of user rights (validation)

One comprehensive portfolio

The Kaba product range includes other products in the same premium design and can be combined seamlessly. Depending on the customer's requirements, they can be integrated into any Kaba standalone or online system.

Note: The functions available depend on the system context in which the product is used.

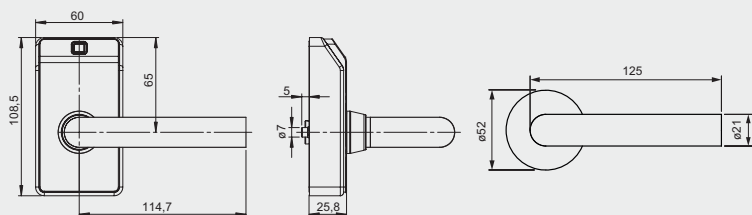

Kaba c-lever compact, type 2725, standard design.

Technical Features

Supported RFID standards

- LEGIC (advant & prime)
- MIFARE (DESFire & Classic)

Designs

- Standard, Half, Dual

Options

- Cover in black or white
- Choice of lever handle designs (see Kaba evolvo catalogue)

Dimensions (W x H x D)

- 108,5 x 60 x 25,8 mm
- Min. backset 45 mm, independent of door and lock

Power supply

- 2 x 1.5V, AAA batteries

Environment / service life

- Temperature: -25 °C to +70 °C
- Protection class: IP54
- Humidity: 0 to 95 %, non-condensing
- Battery service life at 20 °C: up to 90,000 cycles or up to 3 years

Certificates

- Building hardware: EN 1906 class 3
- Fire safety: DIN 18273 (tested as per EN 1634-1)
- Emergency exit: EN 179 (in combination with corresponding door handles and locks)

boadaGRUP

SEGURETAT
ENERGIA
R+D+I

P.A.E. d'Osona C. Tarragona 14
08500 Vic (Barcelona)
T 93 886 01 76 F 93 889 02 25
comercial@mboada.com
www.mboada.com

Further details and order information
can be found in the relevant Kaba evolvo
catalogue or system description



Certified Management
System, ISO 9001,
Reg. No. 14572